

# HOF7DE 750V DC 125A-630A

## Class of operation aR

Standard/ IEC 60269-4 GB/T 13539.4 UL248-13

**INTERRUPTING CAPACITY /**  
50,000 amperes at 750V DC

Dimensions/ : Unit mm

Type-A

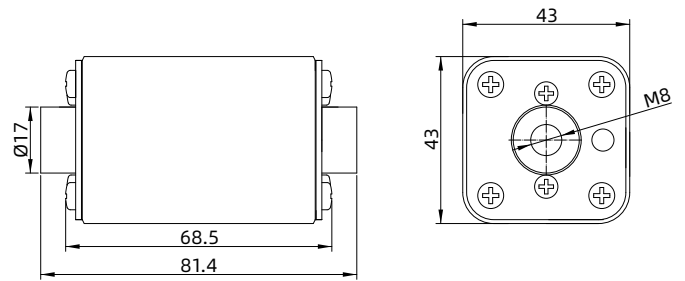

**TECHNICAL PARAMETERS/** :

PART NO.	CURRENT RATING	Rated Voltage	SAFETY APPROVALS	
			TUV	cURus
Type-A No Visual Indicator				
HOF7DE125	125A			
HOF7DE160	160A			
HOF7DE200	200A			
HOF7DE250	250A			
HOF7DE315	315A			
HOF7DE350	350A	750V DC		
HOF7DE400	400A			
HOF7DE450	450A			
HOF7DE500	500A			
HOF7DE550	550A			
HOF7DE630	630A			

DENOTES FOR APPROVAL

DENOTES FOR PENDING